

Specification

- DEMOLITION

Removal of damaged or detached tiles.

- LEVELLING

To even out the surface from which the tiles have detached, levelling with thixotropic cement-based skimming plaster in layers 2 to 10 mm thick, such as Technokolla's **RASO**, which conforms to European standard **EN 13813**, class **CT C12 F4**, or, for layers 3 to 30 mm thick, **GAP** or **GAP-R**, which conform to European standard **EN 1504-3**, class **R2 PCC**.

Amount required:

1.6-1.7 kg/m² for every mm of thickness

- WATERPROOFING

Waterproofing coat obtained with cement-based two-pack anti-carbonatation skimming plaster conforming to European standard **EN 1504-2** class **PI-MC-IR**, certified as being fit for waterproofing by **SÄUREFLIESNER-VEREINIGUNG E.V.** and class **CM OP** in accordance with standard **EN 14891**, such as Technokolla's **RASOLASTIK**, applied in 2 coats with a flat trowel for a 3 mm overall thickness, reinforced with **RASOLASTIK-NET** in the first coat and with Technokolla's **BANDELLA RL 120** strips for sealing the corners, edges and expansion joints.

Amount required:

2.0 kg/m² for every mm of thickness

- FLOORING

Flooring and skirting in ceramic tiles up to the 2000 cm² format suitable the outdoor use, fixed with highly flexible cement-based adhesive such as Technokolla's **TECHNOSTAR HD**, which conforms to European standards **EN 12004 C2TE** and **EN 12002 S1**, or **TECHNO-ONE HD**, which conforms to European standard **EN 12004 C2TE**, for formats of up to 900 cm².

4-5 mm joints grouted with low modulus cement-based grouting for outdoor use, such as Technokolla's **TOPSTUK**, which conforms to European standard **EN 13888 CG2**.

Floor-skirting joint and fractioning joints every 12 m², sealed with silicone sealant such as Technokolla's **ACESIL-310** after the substrate has been prepared with **PRIMERSIL** primer applied with a brush throughout the entire depth of the joint and with synthetic cord positioned successively. To proceed in the correct way, it is advisable for the silicone sealant to be applied before grouting with cement-based products.

Amount of adhesive required:

TECHNOSTAR 4 kg/m²

TECHNO-ONE 4 kg/m²

Amount of grouting required:

0.35 kg/m² (30x30 cm format, 4 mm joints)

- Create expansion joints every 12 m² of tiled floor surface
- Certified high-performance adhesives
- The joints must be at least 4 mm wide
- The tile formats must not exceed 900 cm² as to check their limits
- Read the technical data sheets of the materials used so to understand the dimensional variations of the materials
- Low modulus adhesives and grouting compounds able lasting seal
- Waterproofing, ones that are able to guarantee a long-
- Use products with a high bonding capacity for
- Thoroughly clean the old flooring
- Just remove the already detached tiles

And we know how to solve them

- Unsuitable adhesives and grouting
- Closely laid tiles
- Tile size or nature unsuitable for outdoors
- Sudden temperature variations and expanding materials
- Remade waterproofing
- Demolition of the existing flooring
- No expansion joints
- Infiltrating water caused by old waterproofing that has deteriorated

We understand the problems

Terraces restoration

Technokolla
system
design
systems

Terraces restoration



08 Terraces restoration

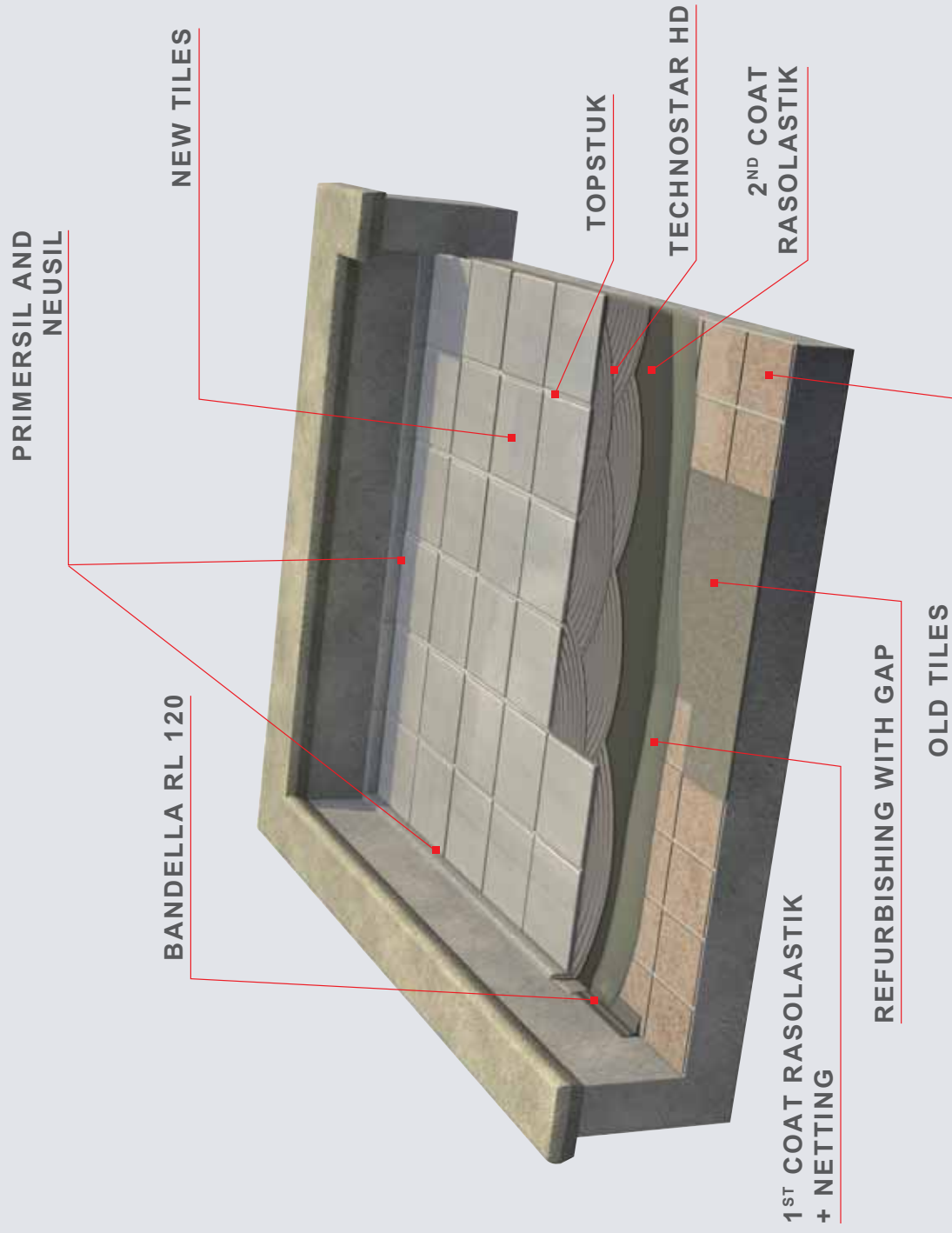

Raso or Gap

Makes up for differences in level where detached or broken tiles have been removed.

RASO conforms to European standard **EN 13813**, class **CTC12F4**. **GAP** conforms to European standard **EN 1504-3**, class **R2 PCC**.



Rasolastik

For refurbishing the waterproofing layer **WITHOUT DEMOLISHING**.

RASOLASTIK guarantees a waterproofing action over time and has been certified as a waterproofing system by the **SAUREFLIESNER-VEREINIGUNG E.V.** institute, in accordance with standard **EN 14891 CLASS CM-OP**. **RASOLASTIK** conforms to European standard **EN 1504-2**, class **PI-MC-IR**.



Techno-One HD Technostar HD

One-pack adhesive suitable for fixing vitrified stoneware outdoors. **TECHNO-ONE HD** conforms to **EN 12004 C2TE** standards.

If the tile format is larger than 33x33 cm, it is advisable to use a highly flexible adhesive such as **TECHNOSTAR HD**, which conforms to standards **EN 12004 C2TE** and **EN 12002 S1**.



Topstuk

Highly flexible, low modulus, water repellent cement-based grouting compound with **S1** classification in accordance with **EN 12002** standards, ideal for cladding that's highly stressed by temperature variations and the weather conditions. **TOPSTUK** conforms to European standards **EN 13888 CG2** and **EN 12002 S1**. All Technokolla's cement-based grouting compounds can be used for this application. In this case, it is advisable to mix the product with **TC-STUK** latex.



Neusil and Primersil

The silicone sealant for filling expansion joints which, used in conjunction with **PRIMERSIL** and synthetic **CORD**, makes the joint long-lasting.



Det-Basico

Fully degrades the old floor surface and prepares the substrate.

RECOMMENDED PRODUCT

Technokolla
system
design
systems

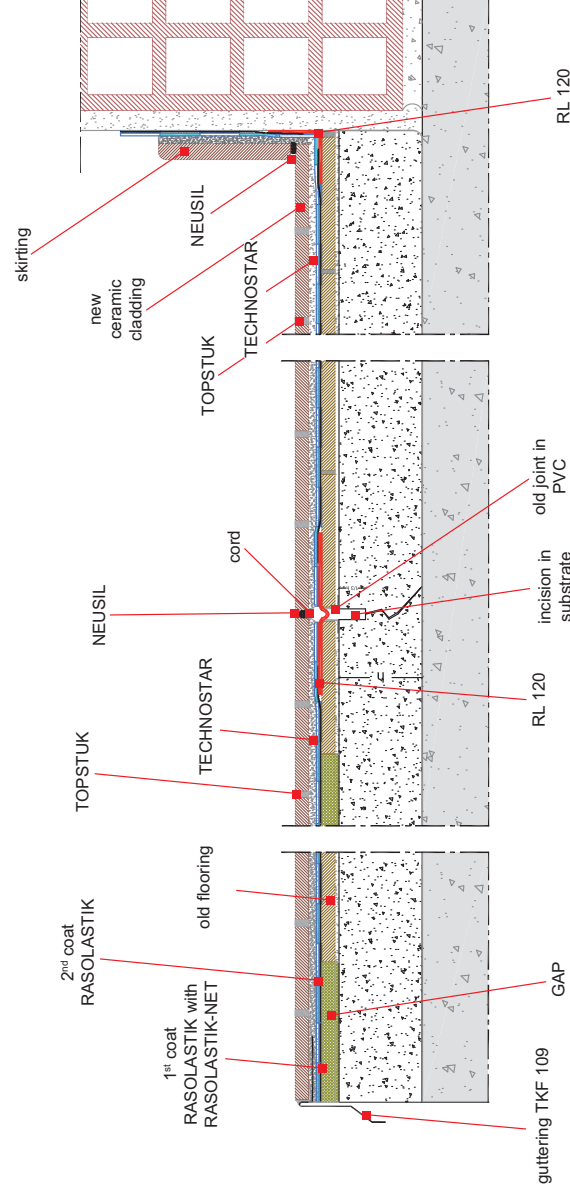

Technical
Drawings