

Specification

- DEMOLITION

Removal of damaged or detached tiles.

- LEVELLING

Levelling with thixotropic cement-based skimming plaster, such as Technokolla's **GAP** or **GAP-R**, which conform to European standard **EN 1504-3**, class **R2 PCC** in layers 3 to 30 mm thick, or **RASO**, which conforms to European standard **EN 13813**, class **CT C12 F4** for layers 2 to 10 mm thick.

Amount required:

1.6-1.8 kg/m² for every mm of thickness

- FLOORING

Flooring and skirting for outdoor use in ceramic tiles in formats up to 2000 cm², fixed with two-pack cement-based adhesive for outdoor use, such as Technokolla's **TECHNOLA** with **TC-LASTIC** or quick-setting adhesive such as **TECHNORAP-2**, which conform to European standards **EN 12004 C2TE**, **EN 12002 S2 (TECHNOLA with TC-LASTIC)**, **C2FT, S1 (TECHNORAP-2)**.

4-5 mm joints grouted with cement-based grouting for outdoor use, such as Technokolla's **TOPSTUK**, which conforms to European standards **EN 13888 CG2** and **EN12002 S1**.

Floor-skirting joints sealed with silicone sealant such as Technokolla's **NEUSIL** after the joint has been prepared with **PRIMERSIL** primer applied with a brush throughout the entire depth of the joint.

To proceed in the correct way, it is advisable for the silicone grouting to be applied before cementitious grouting.

Amount of adhesive required:

4.5 kg/m²

Amount of grouting required:

0.35 kg/m² (30x30 cm format, 4 mm joints)

- Do not demolish the old flooring, just remove the already detached tiles
- Thoroughly clean the old flooring
- Find out whether natural joints have formed in the old flooring. If this is the case, comply with them when the new material is laid
- Low modulus adhesives and grouting compounds able to withstand the dimensional variations of the materials used
- Read the technical data sheets of the materials used so as to check their limits
- The tile formats must not exceed 900 cm²
- The joints must be at least 4 mm wide
- Certified high-performance adhesives
- Maintain the existing joints or make new ones every 12 m² of tiled floor surface

And we know how to solve them

- Demolition of the existing flooring
- No expansion joints
- Sudden temperature variations and expanding materials
- Very approximate cleaning of the existing floor
- Tiles of an unsuitable size or nature for outdoors
- Closely laid tiles
- Unsuitable adhesives and grouting

We understand the problems

Outdoor overtiling

Outdoor overtiling



www.layout.it

Technokolla S.p.A.
Via Radici in Piano, 558
41049 Sassuolo (MO) • Italy
Tel. +39 0536 862269
Fax +39 0536 862660

www.technokolla.com
marketing@technokolla.com

Outdoor overtiling

PRIMERSIL AND NEUSIL

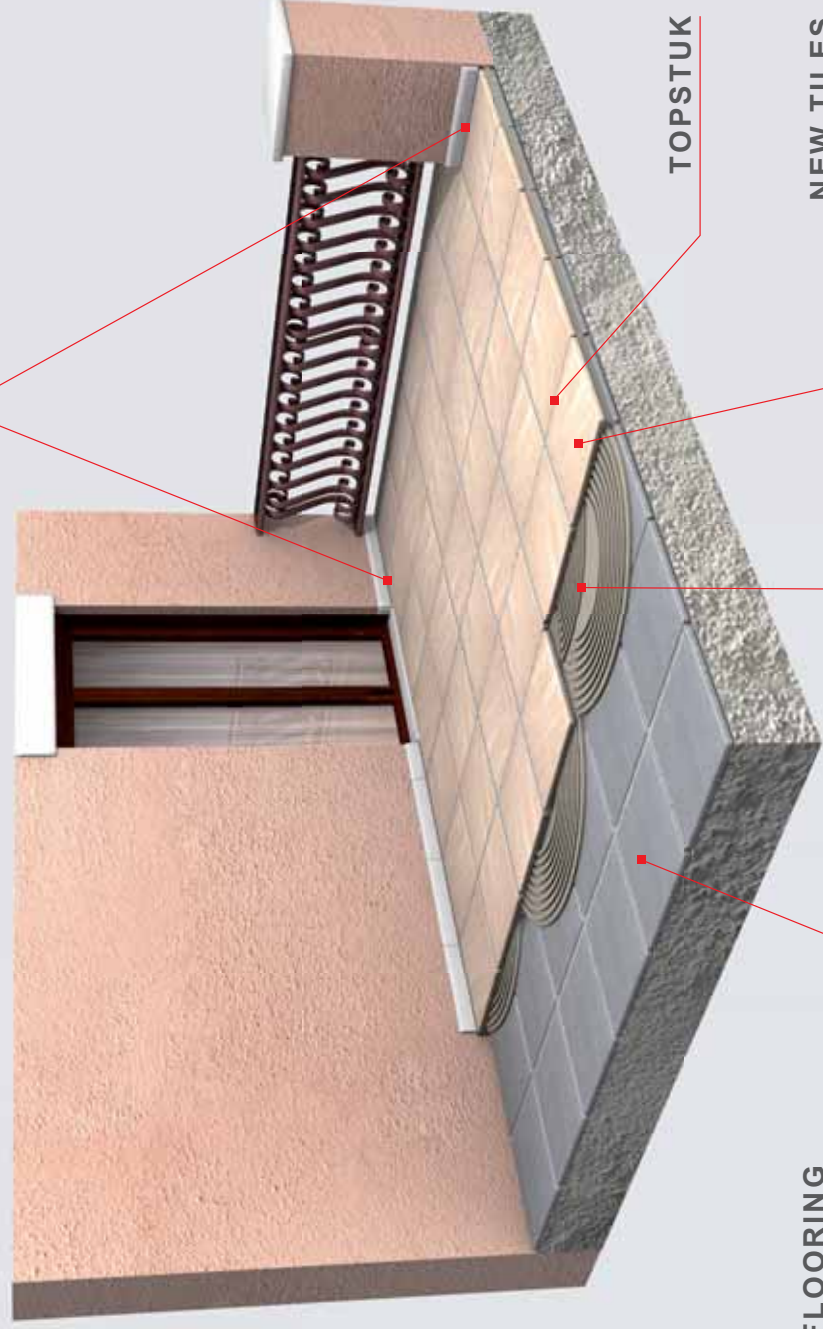

TOPSTUK

NEW TILES

OLD FLOORING

TECHNORAP-2



Det-Basico

Fully degrades the old floor surface and prepares the substrate.

RECOMMENDED PRODUCT



Raso or Gap

Makes up for differences in level where detached or broken tiles have been removed.

RASO conforms to European standard **EN 13813**, class **CTC12F4**.
GAP conforms to European standard and **EN 1504-3**, class **R2 PCC**.



Technorap-2

The highly flexible two-pack adhesive suitable for fixing vitrified stone-ware and natural stones outdoors. Can be used for formats no larger than 2000 cm².

TECHNORAP-2 conforms to European standards **EN 12004 C2FT**, **EN 12002 S1**.



Technola with Tc-Lastic

The highly flexible two-pack adhesive suitable for fixing vitrified stone-ware and natural stones outdoors. Can be used for formats no larger than 2000 cm².

TECHNOLA with **TC-LASTIC** conforms to European standards **EN 12004 C2TE**, **EN 12002 S2**.



Topstuk

Low modulus, mould-proofing and water repellent grouting for cladding that's highly stressed by temperature variations and the weather conditions.

TOPSTUK conforms to European standards **EN 13888 CG2** and **EN 12002 CLASS S1**.



Technokolla
system
design
systems

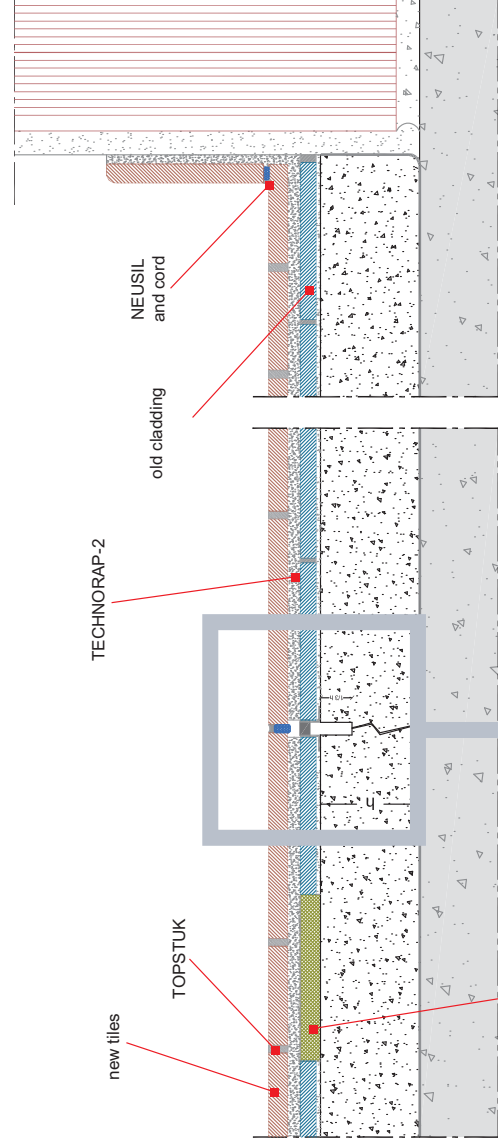

new tiles

TOPSTUK

TECHNORAP-2

NEUSIL and cord

old cladding

GAP

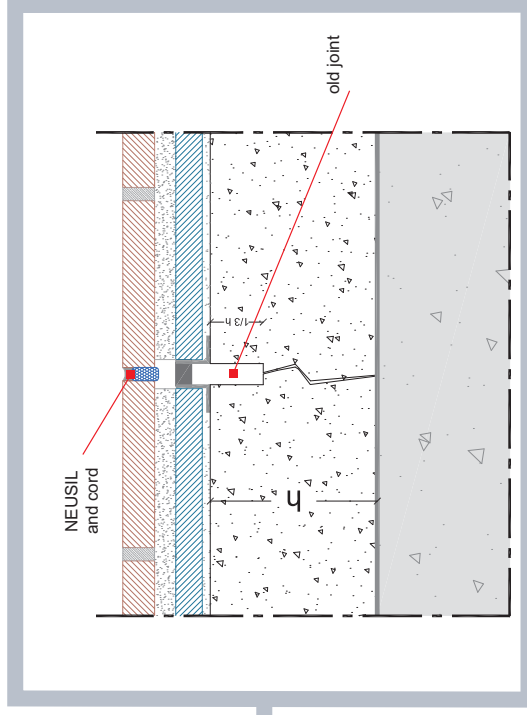

Technical Drawings



Neusil and Primersil

The silicone sealant for filling expansion joints which, used in conjunction with **PRIMERSIL** and synthetic **CORD**, makes the joint long-lasting.

