

Specification

- SCREED

Cementitious mortar screed at least 3 cm thick made of quickly evaporating, quick-setting binder such as Technokolla's **TIMER-2** or quickly evaporating and normally setting binder such as Technokolla's **KRONOS**, plus siliceous aggregates with 0 to 8 mm continuous grain size, reinforced with synthetic fibers and/or metal netting.

The resistance of screeds made of **TIMER-2** must be ≥ 25 N/mm² after 24 hours and ≥ 45 N/mm² after 28 days, while it must allow the solid and/or pre-finished parquet to be fixed 24 hours after application.

The resistance of screeds made of **KRONOS** must be ≥ 30 N/mm² after 28 days and allow the solid wood and/or pre-finished parquet to be fixed 10/-15 days after application.

Screed reinforcing with fiber such as Technokolla's **FS-18** and/or \varnothing 2 mm 5x5 cm mesh galvanized metal netting positioned at 1/3rd of the screed layer.

Dosage for 1 m³ of 0 to 8 mm aggregate:

350 kg **TIMER-2**, 160 l water, 1 kg **FS-18** fiber;

250 kg **KRONOS**, 150 l water, 1 kg **FS-18** fiber.

- FLOORING

Wooden flooring on screeds made of **KRONOS** with residue humidity not exceeding 2%, using two-pack epoxy-polyurethane adhesive such as Technokolla's **WD-900** or **WD-GEO**.

Amount of adhesive required: 1-1.2 kg/m².

- Quick-drying substrates
- Use quick-setting products
- The finishing degree of the substrate must be optimum and there must be no shrinkage which would create cracks
- Create the ideal conditions for correct fixing (windows installed, plastering cured, etc.)

And we know how to solve them

- Excessively damp substrates
- Substrates that require a very long time for curing
- Irregular substrates
- Humidity rates in the wood that make it unsuitable for fixing

We understand the problems

Fixing parquet

Technokolla
system
design
systems

Fixing parquet



www.layout.it

TECHNOKOLLA >>

Technokolla S.p.A.
Via Radici in Piano, 558
41049 Sassuolo (MO) • Italy
Tel. +39 0536 862269
Fax +39 0536 862660

www.technokolla.com >>
marketing@technokolla.com



TECHNOKOLLA >>

12

TECHNOKOLLA >>

12 Fixing parquet

PARQUET

WD-900

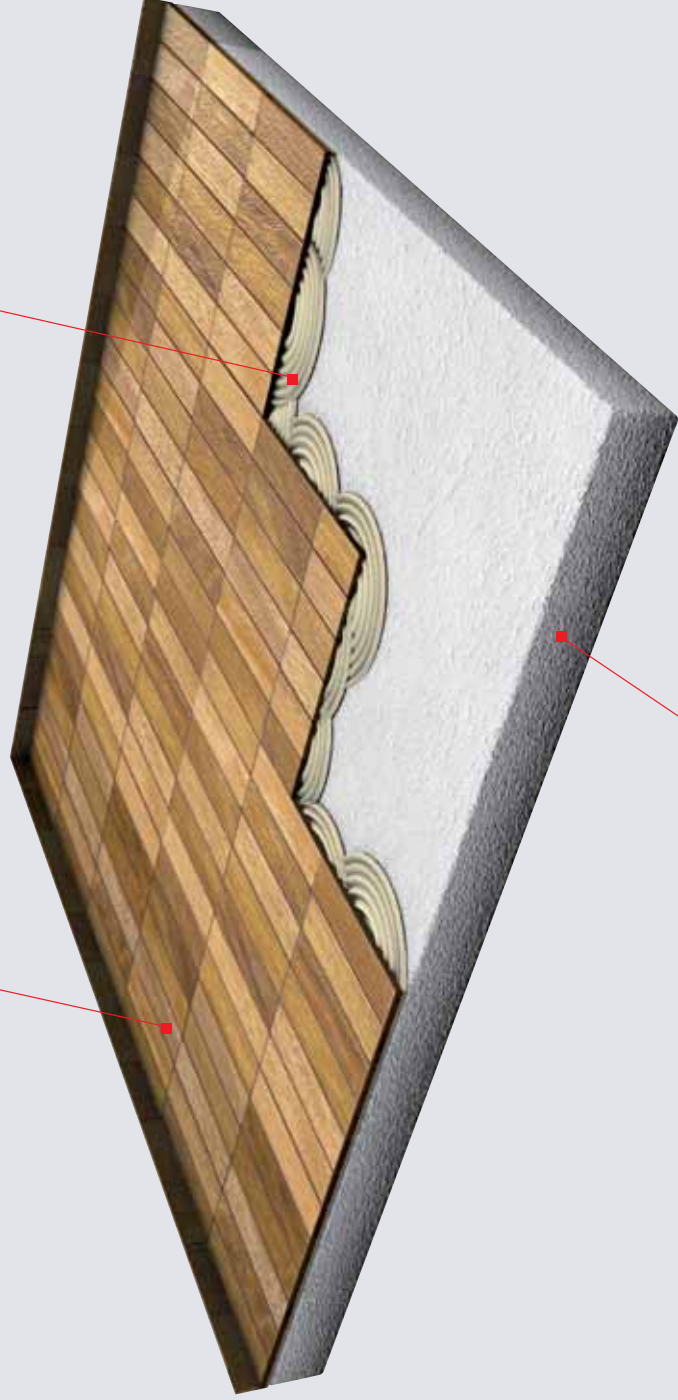

TIMER-2 WITH FS-18 FIBERS



Timer-2

Binder for making quick drying and setting indoor screeds. Allows **parquet flooring to be laid after just 24 hours**. >45 MPa compressive strength after 28 days is guaranteed. Recommended thickness min. 3, max. 8 cm.

R E C O M M E N D E D P R O D U C T



Kronos

This is the binder to use instead of cement to form the screed. Guaranteed quick-setting with very low shrinkage, allowing **the parquet to be laid after about 4 days**. Guarantees > 30 MPa compressive strength. Recommended thickness min. 4, max. 8 cm.

R E C O M M E N D E D P R O D U C T



Wd-900

Water-free **two-pack epoxy-polyurethane** adhesive for fixing parquet flooring of all types. Also suitable for fixing parquet on existing floor surfaces so long as they are non-absorbent, such as marble, tiles, etc., and on heating screeds.

R E C O M M E N D E D P R O D U C T



Wd Geo

Two-pack **solvent-free hyposallegenic** adhesive for parquet flooring. **WD-GEO** is classified as a non-hazardous product. Suitable for fixing parquet of the following types: Laminated, Industrial, Lamparquet, Narrow strips, Pre-surfaced and Pre-finished.

R E C O M M E N D E D P R O D U C T



Technical Drawings

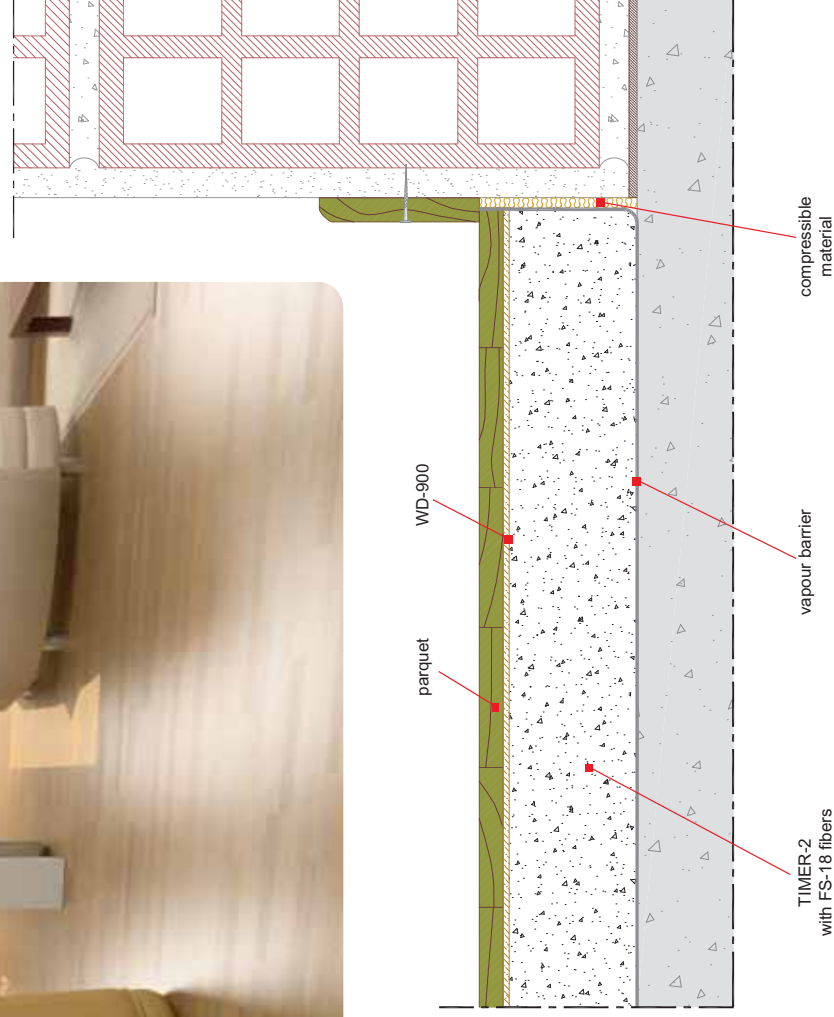

Technokolla
system
design
systems